

HIGHLIGHTS 2019



Joyce Taylor Pledges Estate Gift

Our committed volunteer and friend Barbara Pass died in January of 2018 and she left much of her estate to The Botanic Garden in the form of an endowment. Whenever Barbara volunteered her sister Joyce Taylor (picture at left) was always by her side. Joyce still volunteers for us every week and keeps the greenhouse and succulent collection growing and in shape. To honor Barbara's memory Joyce has pledged an estate gift that will be added to the Barbara Pass Endowment. Endowment gifts are so important to the long-term viability of the garden and we thank Joyce for making such a valuable pledge in memory of her sister.



Laura Payne Wins Oklahoma Horticultural Society Award

Our own Laura Payne was awarded the George J. Vaclavek Gold Medal at the Oklahoma Horticultural Society fall meeting. The Vaclavek Gold Medal is presented to outstanding members of Oklahoma's horticultural community and Laura has been earning that moniker since becoming the first graduate of OSU's Public Horticulture program in 2001. We know her as our events coordinator, volunteer coordinator, *Oklahoma Gardening* (OKG) field producer, counselor, public relations specialist, and friend. Congratulations Laura! Laura is pictured on the right with OKG host Casey Hentges on the left.



Dr. Ray Campbell Gives Lead Gift for Greenhouse Remodel

When our only remaining greenhouse started showing signs of wear we knew we needed to take drastic action. With help from Ambassadors, students, and staff the greenhouse was completely remodeled this fall and finished just hours before the first cuttings were brought in for the winter. Ray Campbell donated funds for the remodel including space saving "rolling" benches. Ray is a former host of *Oklahoma Gardening* (among other jobs at OSU), a Friends of The Botanic Garden board member, and forever dedicated to the garden. Thank you Ray!

FRIENDS OF TBG BOARD

Jan McSwain | President
 Lou Anella | Director
 Jen Anthony
 Ann Berry
 Jeneane Campbell
 Ray Campbell
 Ann Halligan
 Rick McSwain
 Kimberly Sadler

Contact us:
 botanicgarden@okstate.edu
 405.744.5404

 THE BOTANIC GARDEN
 OKLAHOMA STATE UNIVERSITY
 358 Ag Hall
 Stillwater, OK 74078

WE THANK THE FOLLOWING FOR THEIR SUPPORT:



Thanks in part to the generosity of the Bobby and Claranne Hayes Family Botanic Garden Student Experience Fund, we were able to hire a fantastic group of interns this year and they are: Jessi Garrett, Blake Kruse, Peyton Osborne, Loren Park, Pam Sharp, and Austin Zielinski. We thank them for their hard work and their smiles!

To make a donation visit: osugiving.com | Friends of the Botanic Garden | Fund # 2178500



Annual Report 2019



A Note from the Director

2019 was a busy year but 2020 promises to bring even greater changes! In 2019 construction of the Treewalk Village (phase one) was completed and we remodeled our production greenhouse. We hope to construct phase two of the Treewalk Village this year and to construct a second production greenhouse but the biggest news is that we have plans to construct a paved road and parking lot at TBG. Please see the plan and article inside. There is so much going on at the garden thanks to the support of many great people. Please visit soon to enjoy all that is happening at TBG. Sincerely, Lou Anella

Lou Anella
 Director

Jane Carter
 Garden Manager

Laura Payne
 Volunteer & Education
 Coordinator



Ambassadors Recognized

We have a committed group of volunteers we call our Ambassadors and this year we recognized the following for their dedication:

Most Volunteer Hours – Ron Carter who does almost all our mowing including mowing of the arboretum, clocked over 400 hours this year keeping our grass looking great.

TBG Outstanding Service Award – Mary Davey shows her dedication by working in the greenhouse helping to manage propagation and by keeping up with announcements on the garden bulletin board.

15 years: Billie Richardson, Jeneane Campbell, John Mills, and Melanie Oliver

10 years: Ann Mitchell, Anne McMurtry, Charlita Tefft, Eloise Triplett, Lynne Miller, Marvie Rotter, Nancy Ussery, and Peter Stroukoff

5 years: Lynn Miler, Mary Davey, and Wanda White

PAVING ROAD TO GARDEN'S SUCCESS!

The Botanic Garden at OSU has long been recognized as a cultural treasure for the City of Stillwater and the OSU campus. Tens of thousands of visitors enjoy the garden and its programming every year. If one has friends or family visiting from out of town or is interviewing a job candidate and wants to show what a great place Stillwater is to raise a family, inevitably those guests are taken to The Botanic Garden where our quality of life here in Stillwater is showcased at its best.

Once guests walk through the gardens they are impressed with the quality of displays, the variety of plant material, and the intimate environment created by garden staff, volunteers, and student workers. They are probably not impressed by their approach to the garden! One must drive on poorly maintained gravel roads to enter the garden from the north or park in a gravel parking lot at the south and walk a fair distance to the garden.

Thanks to support from the University Administration, The Botanic Garden at OSU will pave a new entrance road from Highway 51 to the garden and pave a parking lot at the southern edge of the manicured gardens!

The paved road will be an enticing and beautiful entrance for all and will give greater access to those with mobility challenges.

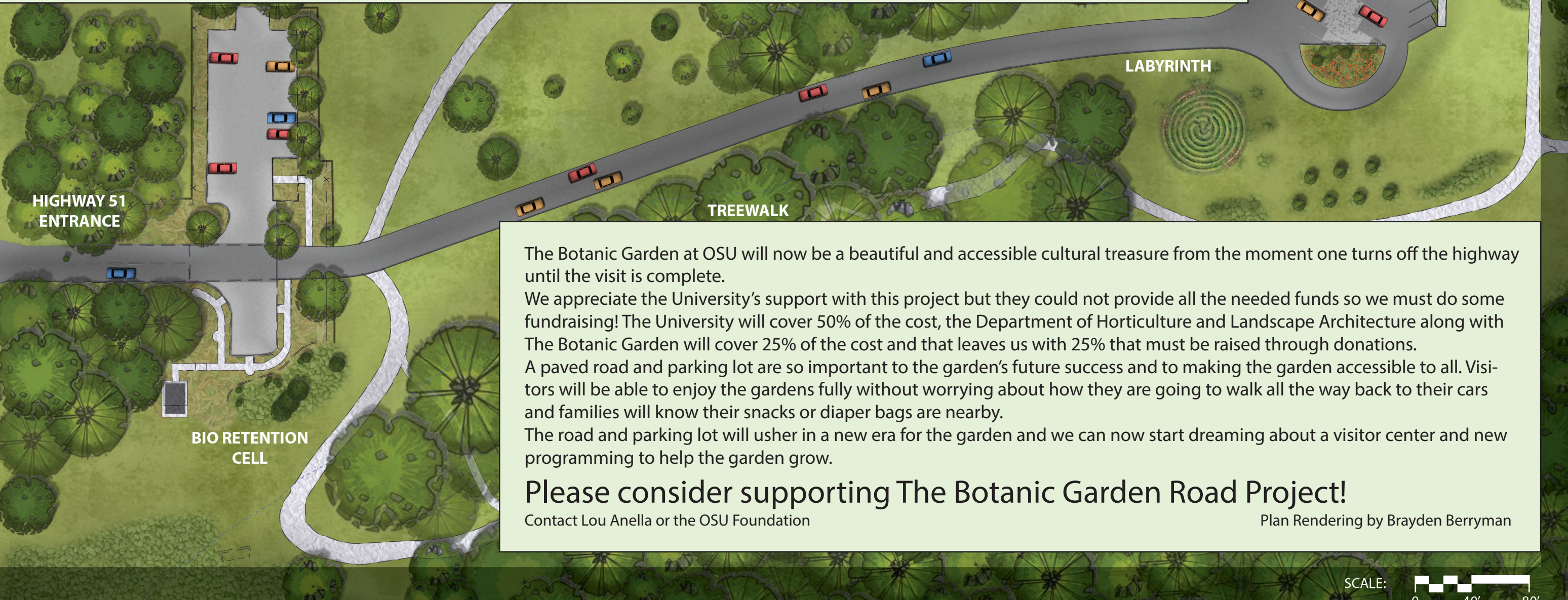

The Botanic Garden at OSU will now be a beautiful and accessible cultural treasure from the moment one turns off the highway until the visit is complete. We appreciate the University's support with this project but they could not provide all the needed funds so we must do some fundraising! The University will cover 50% of the cost, the Department of Horticulture and Landscape Architecture along with The Botanic Garden will cover 25% of the cost and that leaves us with 25% that must be raised through donations. A paved road and parking lot are so important to the garden's future success and to making the garden accessible to all. Visitors will be able to enjoy the gardens fully without worrying about how they are going to walk all the way back to their cars and families will know their snacks or diaper bags are nearby. The road and parking lot will usher in a new era for the garden and we can now start dreaming about a visitor center and new programming to help the garden grow.

Please consider supporting The Botanic Garden Road Project!
 Contact Lou Anella or the OSU Foundation Plan Rendering by Brayden Berryman

We thank the following for their support!

Benefactor	Sponsor	Patron
Marsha Adams Lou and Shelley Anella Jeneane Campbell Dr. Ray Campbell Mary and Ken Davey Tabitha Doescher and Josh Wiener Virginia Eggers Rick and Jan McSwain Russ and Donna Rhinehart Matt and Kristine Waits Aihua Xie	Anonymous Jen and Luke Anthony Jim and Ann Berry Tom and Krystal Hennessey Lynn Hughes Judy Hull Paige Martin and Paul Clear Lynne Miller Wyche and Mary Murphy Real Estate Professionals Laura and Mike Shaw	Anonymous (3) Merry Alexander John and Nancy Allford Eric Broadway Vikki Brown-Beier Marleigh and Brian Dougherty Karen and Tommy Edgar First National Bank & Trust Company of Weatherford – Morrison Branch Keith and Christine Garbutt Joshua and Amie Haar Kathy and Doug Hall Jim and Ann Halligan Skip and Priscilla Iba Paul and Alice Richardson Darrell and Kimberly Sadler Connie and Lanny Sells Heidi and Elliott Williams Constance and Drew Williamson



Sustaining	Sustaining Continued	Contributing
Anonymous (2) Gladeen Allred Linda and Calvin Anthony Ed and Andrea Arquitt Catherine and Ronald Barney Roy and Carole Bays Frank and Linda Blum Peter and Linda Clark Steve and Lisa Cummings Megan Downing Damona Doye Holly Ewing Inez and Steven Fasold Roger Gose Fred and Linda Guthery Nancy and Fred Helms Larry and Judy Hoberock Angela and William Holle Kim and Michael Holmes Ann Houston Rick and JanEtte Jungers Kay County Master Gardeners Meg and Darrel Kletke Gerald and Jolene Klingaman Katherine M. Kocan Craig Maile and Diana Watson-Maile Robert Mayer and Elizabeth Williams Jean and Paul McMullen Anne and Leonard McMurtry	Linda and John Mes Mark and Shayna Paden Richard and Norma Payne Carol Ann Powell Dennis and Carol Preston John and Sandy Rooney Jim Rutledge Susan Holmes Seely Debbie Skinner Jeanie Smith Sheryl Stice Smith Tom and Carol Stewart Liz and Ron Tarbutton Judy Turner Sarah Diehl Voegeli Annette Wallace Ann Watkins	Kim and Kathryn Anderson Dale and Beth Atess Dennis and Loretta Bertholf Karen and Patrick Bertrand Susan and David Chastain Sandra Clemons Dick and Malinda Fischer Joyce Hise Debbie Hooper and Tim Dolezal Ann Houston Juergen and Lorrie Janzen Marjory LeMaster Eve and Simon Ringsmuth Elizabeth and Brad Scott Toni and Bill Stone Teresa and Olen Thomas Odell and Marlene Walker Lou and Wes Watkins John and Becky Womack

Concert Series and Pony Ride Sponsors

Allergy Partners of Oklahoma
 B&L Heating and Air Conditioning
 The Hideaway
 OSU Office of the President
 Stillwater Designs – Kicker